

## CAST IRON OR DUCTILE IRON BALL CHECK VALVE

### DESIGN DESCRIPTION:

- Design: DIN3352;
- Manufacture: Factory STD;
- Face To Face: DIN 3202-F1/F6
- Flange: DIN 2532/2533;
- Bolt Cover;
- Ball Seal;
- Material and Working Temp.:
  - ◆ Cast Iron and Ductile Iron: 0 °C-200 °C(32°F -392°F)
  - ◆ Buna-N:0 °C- 71 °C(160°F) Maximum
  - ◆ EPDM: :0 °C-80 °C(300°F) Maximum



### PARTS AND MATERIAL:

NO	PARTS NAME	MATERIALS
1	Screw & Bolt	CARBON STEEL OR STAINLESS STEEL
2	CAP	ASTM A126-B/A536,DIN GG25/GGG40
3	GASKET	NBR / EPDM
4	BALL	NBR / EPDM
5	BODY	ASTM A126-B/A536,DIN GG25/GGG40

OTHER MATERIALS ARE AVAILABLE UPON REQUEST.

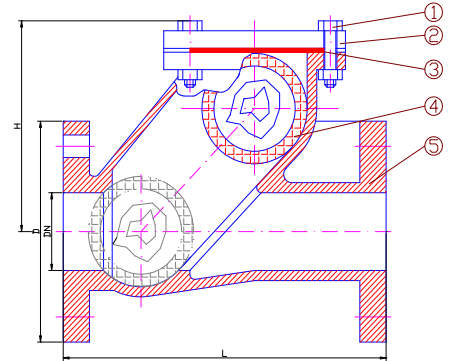

### DIMENSIONS LIST(UNIT:MM):

DN	40	50	65	80	100	125	150	200	250	300
L(F1)	200	230	290	310	350	400	480	600	730	850
L(F6)	180	200	240	260	300	350	400	500	600	700
H	120	125	130	160	185	195	205	285	320	340
PN10										
D	150	165	185	200	220	250	285	340	395	445
PN16										
D	150	165	185	200	220	250	285	340	405	460

✧ We hereby reserve the rights of any alternative dimension that would help to improve our valve's quality and working efficiency.